



CHARING CROSS



**MODERN. CLASSIC.**

For 140 years, the Charing Cross Hotel has stood as a monument to the confidence and vision of the Victorian railway pioneers. Its grand scale and magnificent architecture hark back to a more genteel age – a unique point of view it faithfully retains as part of the Guoman collection. And with its superb facilities and impeccable service, it sets new standards of excellence for our own century too.



**INDIVIDUAL. ATTENTION.**

Unobtrusive, yet efficient service – another Victorian virtue, carefully maintained. From our event creator to help with your planning, to your dedicated service contact on the day, you'll be in the best possible hands at every stage. And with exclusive menus including healthy, savoury and sweet options, we can literally cater for your every requirement. Because we always remember whose event this is.



**GRAND. DESIGN.**

You have to hand it to Edward Middleton Barry. Most architects, if they'd designed the Royal Opera House at Covent Garden, would consider their career complete. For Barry, however, it was merely the overture to his masterpiece, the Charing Cross Hotel. And here in the Betjeman Suite, we see him at the height of his powers. The marble pillars, the dance floor, the elegant sculpted ceiling and glittering chandeliers are exactly as they would have been in their Victorian heyday. They really don't build them like this any more.

**SOCIAL. FUNCTION.**

Gala dinner, charity ball, product launch or corporate reception – whatever the occasion, the grandeur of the Betjeman Suite can comfortably accommodate your event, and your guests. And we do mean comfortably, with air-conditioning, and a separate break-out area for buffets and refreshments giving maximum space to mingle.





**DETAILED. ARRANGEMENTS.**

The same period elegance, on a more intimate scale. We've the Victorian designers to thank for the natural daylight that floods our meeting rooms: the technology, in contrast, is as up-to-date as it comes.

**PRIVATE. DISCUSSION.**

A world away from the city's bustle, our rooms are perfect for executive meetings, and gatherings demanding quiet and privacy.



**TABLE. TALK.**

Sumptuous food, glorious wines, immaculate surroundings. Private dining, perfected.



**CONNECTING. ROOMS.**

Bring everyone together in the Betjeman Suite, then arrange as many of the adjoining rooms as you need for training sessions, seminars and smaller group discussions.



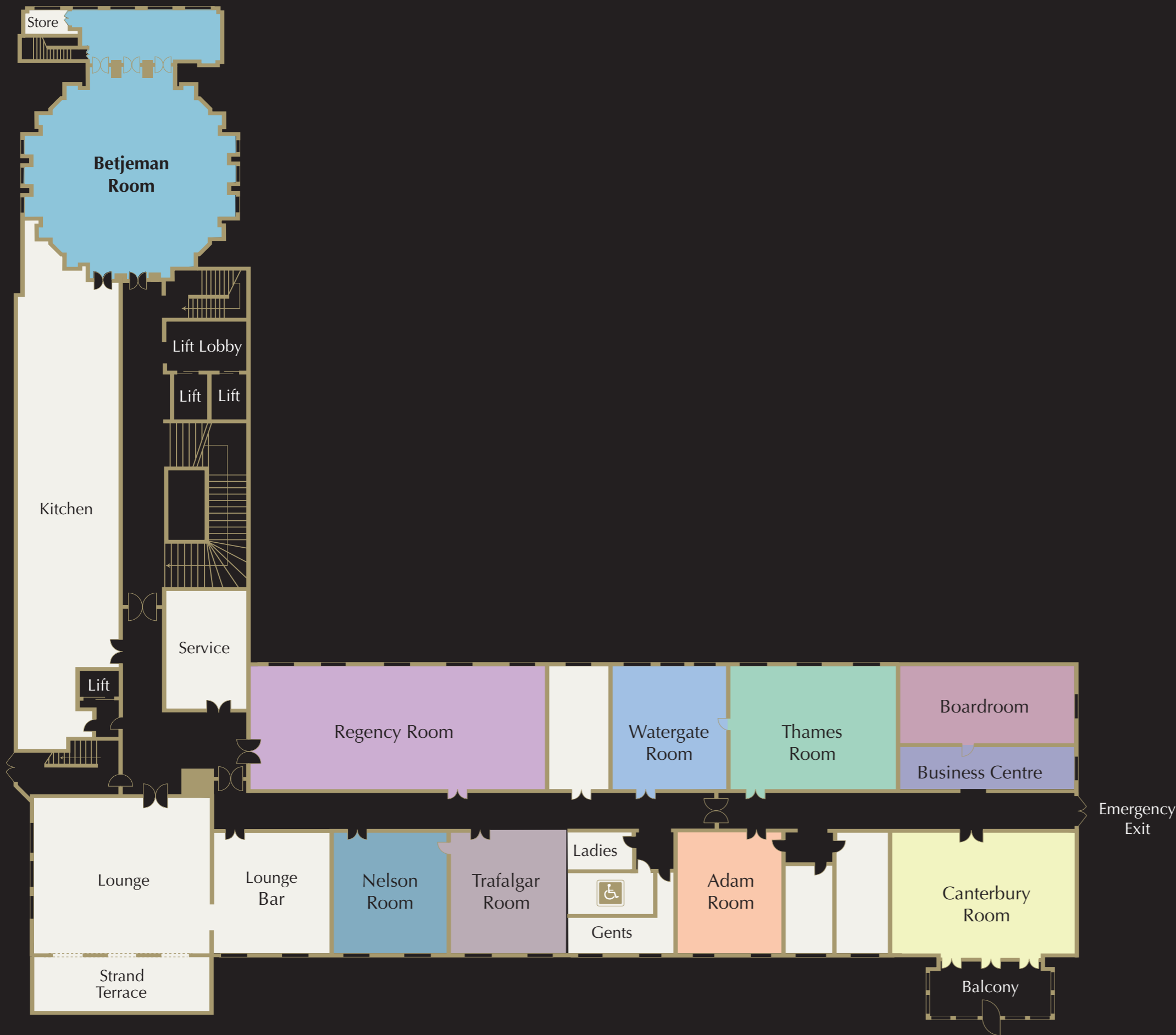

**SELECT. COMPANY.**

Our meetings and events facilities are entirely self-contained, giving you the privacy you need to focus on business, or enjoy your big day in uninterrupted splendour. And with broadcast facilities and high-speed BT Openzone internet connection throughout, you can stay in touch, even though you're out of the office.

Name of Room	Theatre	Classroom slims	Boardroom	U-shape	Cabaret
Nelson Room	30	20	16	20	24
Trafalgar Room	30	20	16	20	24
Adam Room	35	24	16	20	24
Canterbury Room	50	40	26	26	40
Boardroom	N/A	16	20	N/A	N/A
Thames Room	70	45	28	32	40
Watergate Room	40	24	18	24	24
Regency Room	112	80	46	48	50
Betjeman Room	140	96	40	46	80

Name of Room	Reception	Dinner Rounds 5ft	Dinner Rounds 6ft	Dinner Dance
Nelson Room	40	30	33	N/A
Trafalgar Room	40	30	33	N/A
Adam Room	40	30	33	N/A
Canterbury Room	70	50	55	40
Boardroom	N/A	N/A	N/A	N/A
Thames Room	70	60	66	40
Watergate Room	40	30	33	N/A
Regency Room	100	70	77	66
Betjeman Room	150	120	130	110



**GENUINE. PLEASURE.**

From the floor-to-ceiling windows of the Terrace on the Strand Restaurant, you can enjoy superb views over the Strand, Trafalgar Square and the historic Eleanor Cross. The menu features the finest cuisine from around the world, prepared using only the very best seasonal ingredients.



**PEACEFUL. OUTLOOK.**

Victorian grandeur, contemporary furnishings and décor, and our staff's discreet yet attentive service make the Strand Lounge a calm, sumptuous place to relax - and experience the unique sense of ordered peace and intimacy.

**RELAXED. AMBIENCE.**

Forget any notions of Victorian stuffiness: our 19th Century Terrace on the Strand Bar has a determinedly 21st Century attitude to life. Friendly and easy-going, it's the perfect place to enjoy a pre-dinner or post work drink, afternoon tea, an informal get-together or a bite to eat.



## HOME. COMFORTS.

Charing Cross is a railway hotel, but at the end of a long day, getting on a train is probably the last thing you feel like doing. Happily, you don't have to. Simply book one of our Executive Rooms or Junior Suites, and as well as a privileged rate, you'll receive access to the comforts of our private Guoman Club lounge which includes a personal welcome from our Guest Relations Manager. So, leave the rush hour to others and enjoy a relaxing evening, and a restful night's sleep. Because while Charing Cross has a strong sense of history, we like to think it has a real feel of home, too.



